





# TM Robot Rugged Solution

Hardware Version: 3.2 and 5.0

Document Version: 1.00

Release Date: 2024-10-07

This Manual contains information of the Techman Robot product series (hereinafter referred to as the TM AI Cobot). The information contained herein is the property of Techman Robot Inc. (hereinafter referred to as the Corporation). No part of this publication may be reproduced or copied in any way, shape or form without prior authorization from the Corporation. No information contained herein shall be considered an offer or commitment. It may be subject to change without notice. This Manual will be reviewed periodically. The Corporation will not be liable for any error or omission.

 and  logo are registered trademark of TECHMAN ROBOT INC. in Taiwan and other countries and the company reserves the ownership of this manual and its copy and its copyrights.

 **TECHMAN ROBOT INC.**

Revision History.....	3
1. Overview .....	4
1.1 Function.....	4
1.2 Specifications .....	4
1.3 End Module .....	5
1.4 Flange Surface .....	7
2. Installation .....	8
2.1 Installation and Operation.....	8

## Figures

Figure 1: Reference of End Module Components (HW 3.2).....	5
Figure 2: Reference of End Module Components (HW 5.0).....	6
Figure 3: Reference of End Module Surface (HW 3.2).....	7
Figure 3: Reference of End Module Surface (HW 5.0).....	8

## Revision History

Revision	Date	Revised Content
1.0	2024-10-07	Original release

# 1. Overview

## 1.1 Function

The Rugged Solution is a series of TM AI Cobots without built-in vision that are better protected against the elements. Please note that a Rugged Solution robot can only be ordered as a complete unit from Techman Robot, and it cannot be modified from any existing TM AI Cobot.

## 1.2 Specifications

Hardware Version	3.2 and 5.0
IP Rating	IP65
Robot Vision	None
Note	<p>(1) The specs are entirely the same as those of TM AI Cobots without built-in vision.</p> <p>(2) There are no physical buttons on the end module. To use the Freebot on a Rugged Solution robot, consult <i>Software Manual TMflow</i> for instructions.</p> <p>(3) The I/O port on the flange is covered with a metal cap.</p> <p>(4) The seal and cover of each joint are improved for better protection.</p>



**CAUTION:**

Do not use a Rugged Solution robot in the following conditions (including but not limited to): corrosive environments, prolonged exposure to liquids, outdoor settings, direct sunlight, explosive atmospheres, electromagnetic interference, vibration, and rain.

### 1.3 End Module

- HW 3.2

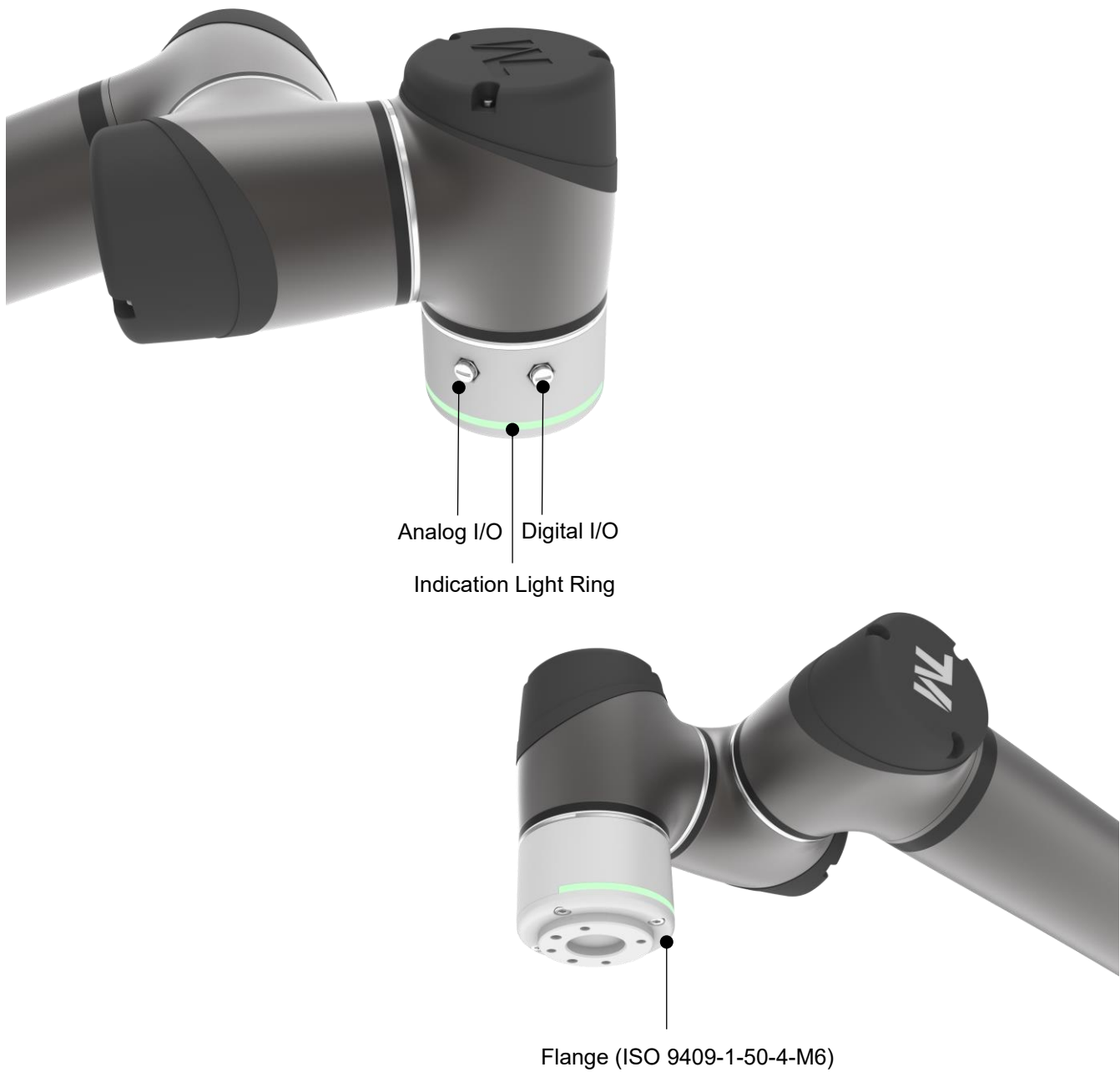

Figure 1: Reference of End Module Components (HW 3.2)

- HW5.0

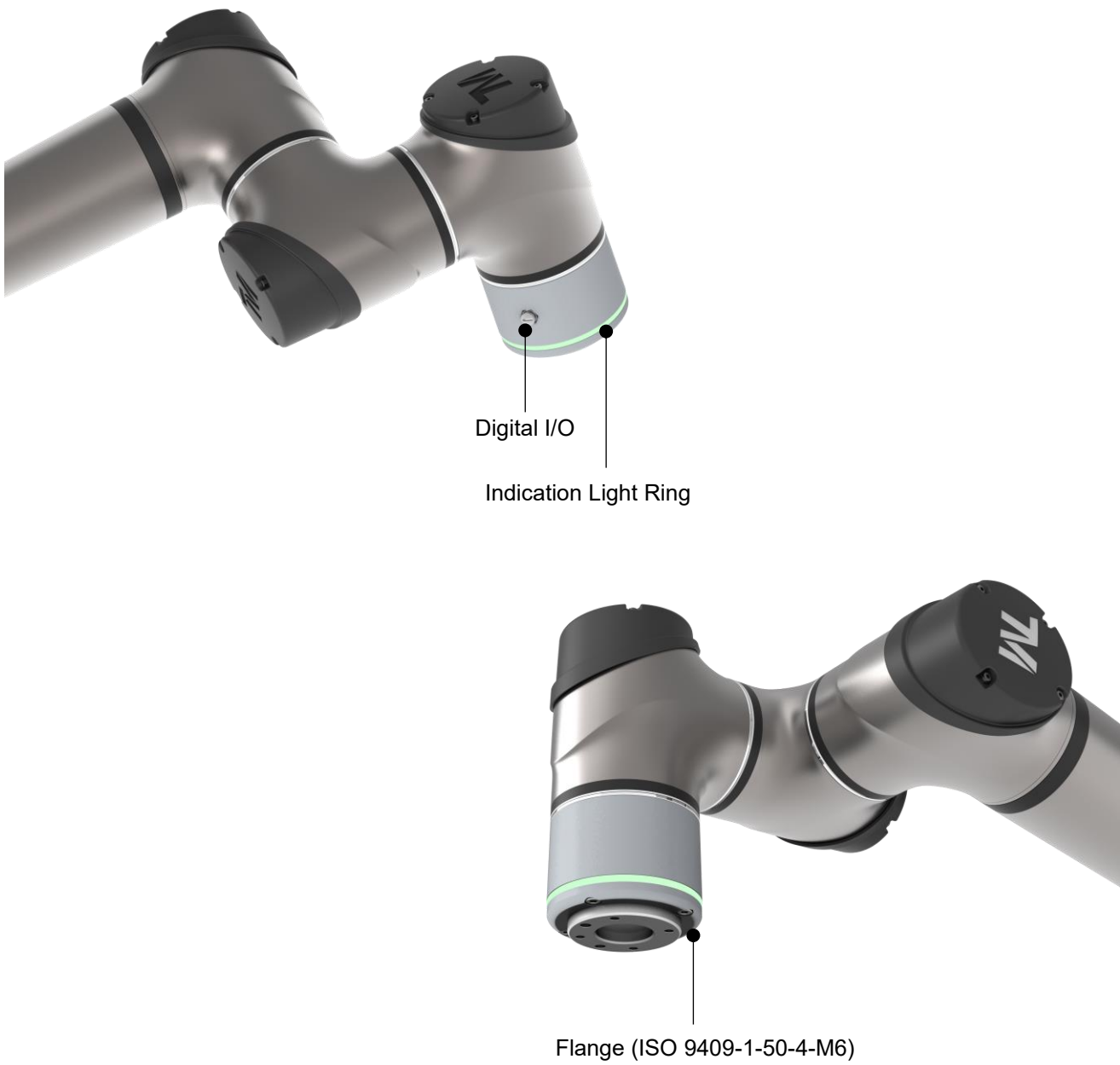

Figure 2: Reference of End Module Components (HW 5.0)

### 1.4 Flange Surface of the End Module

- HW 3.2

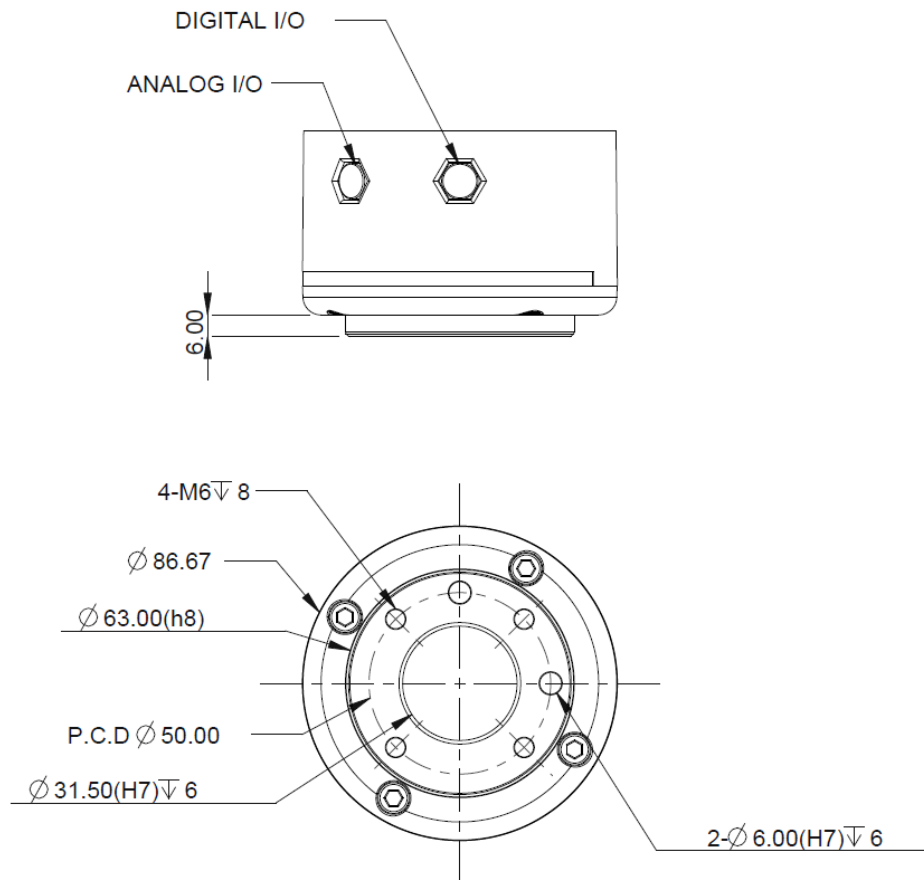

Figure 3: Reference of the Flange Surface of the End Module (HW 3.2)

\*All measures are in mm



- HW5.0

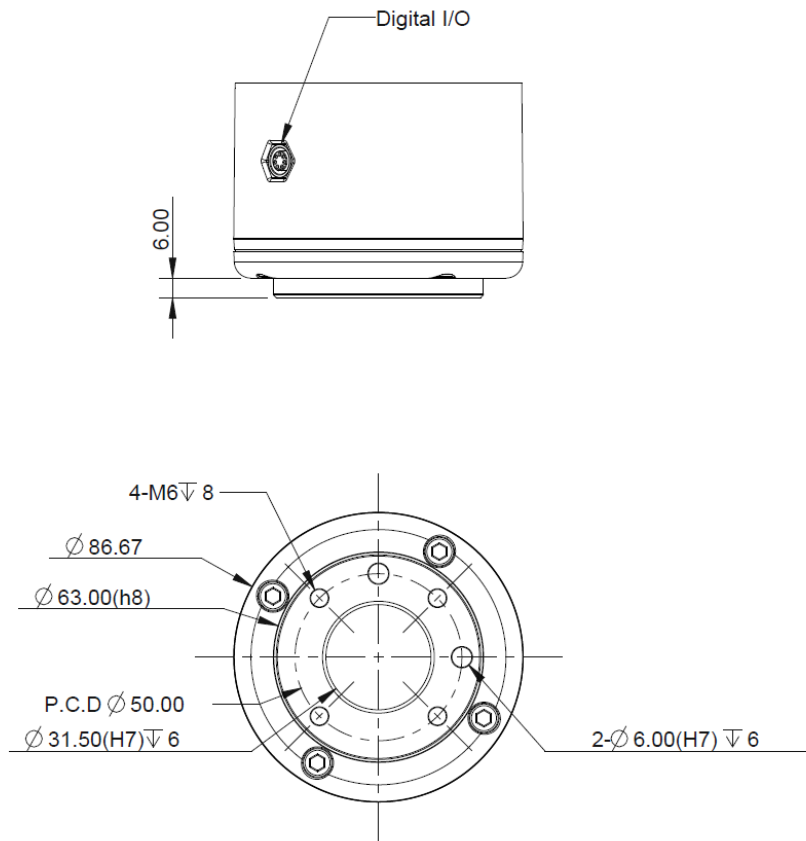

Figure 4: Reference of End Module Surface (HW 5.0)

\*All measures are in mm

## 2. Installation

### 2.1 Installation and Operation

Please refer to a *Hardware Installation Manual* or *Service Manual* for instructions.

 **TECHMAN ROBOT INC.**